

HEAVY? AWKWARD? BRING IT ON!

We all know installing panel siding can be a tedious job. *It's big. It's heavy.* Also, making sure you maintain the manufacturer-recommended siding-to-flashing gap is another challenge.

That's all about to change. Introducing the Z-CLAMP from Pactool International.

The Z-CLAMP makes installing panel siding easier, faster, and safer. It also makes one-person installation a reality.

Working as a pair, the unique design grips tightly to Z flashing — creating a stable platform to support each panel while nailing. It also creates the proper siding-to-flashing gap to allow moisture drainage.

Simply attach each Z-CLAMP to your first course of flashing, then place siding panel on the Z-Clamp support plates, position, and nail. It's that easy!



To adjust siding-to-flashing gap, simply remove or add the included spacer plates. Sliding the spacer plates forward adjusts for the siding thickness, while the tension knob adjusts for flashing thickness.

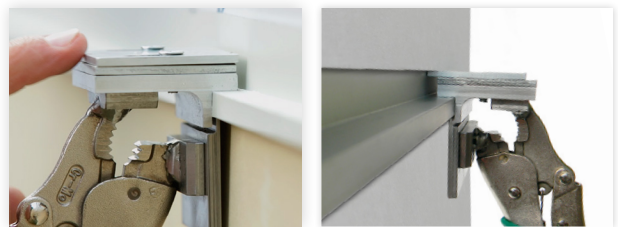

Stop wrestling heavy panel siding, ditch those cumbersome homemade spacer guides, and let the Z-CLAMP add safety and stability while reducing labor cost.

Learn more about the Z-CLAMP and our other incredible time saving tools — visit pactool.us or call 800.397.7487 today!

Z CLAMP™

by Pactool International

- Supports many types of panel siding for nailing
- Adjusts for all siding thicknesses and siding-to-flashing gaps
- Durable machined construction



Scan code to see the Z-CLAMP in action!

**SMART
TOOLS
MADE FOR
SMARTER
BUILDERS.**

PACTOOL
INTERNATIONAL